

Retrofit Unit Installation

Follow these instructions to install a drying and tracking retrofit unit or tracking retrofit unit to an Evolve cabinet with adjustable scope managers and cord retainers.

Tools needed

- Drill with #2 Phillips bit or a Phillips screwdriver
- Drill extender
- Drill with 7/64 bit
- Level

Included:

1. Compressor
2. 4 #8 x 3/4" wood screws
3. Manifold
4. Tube management strip
5. Cord retainer
6. Compressor tube/air filter
7. 16½"-long cable raceway
8. 13½"-long cable raceway
9. Corner cable raceway
10. Replacement door with 10" touchscreen
11. Manifold tubing set
12. 2' cable
13. 5' cable
14. Dual power cord
15. Compressor mounting template (attached to instructions)

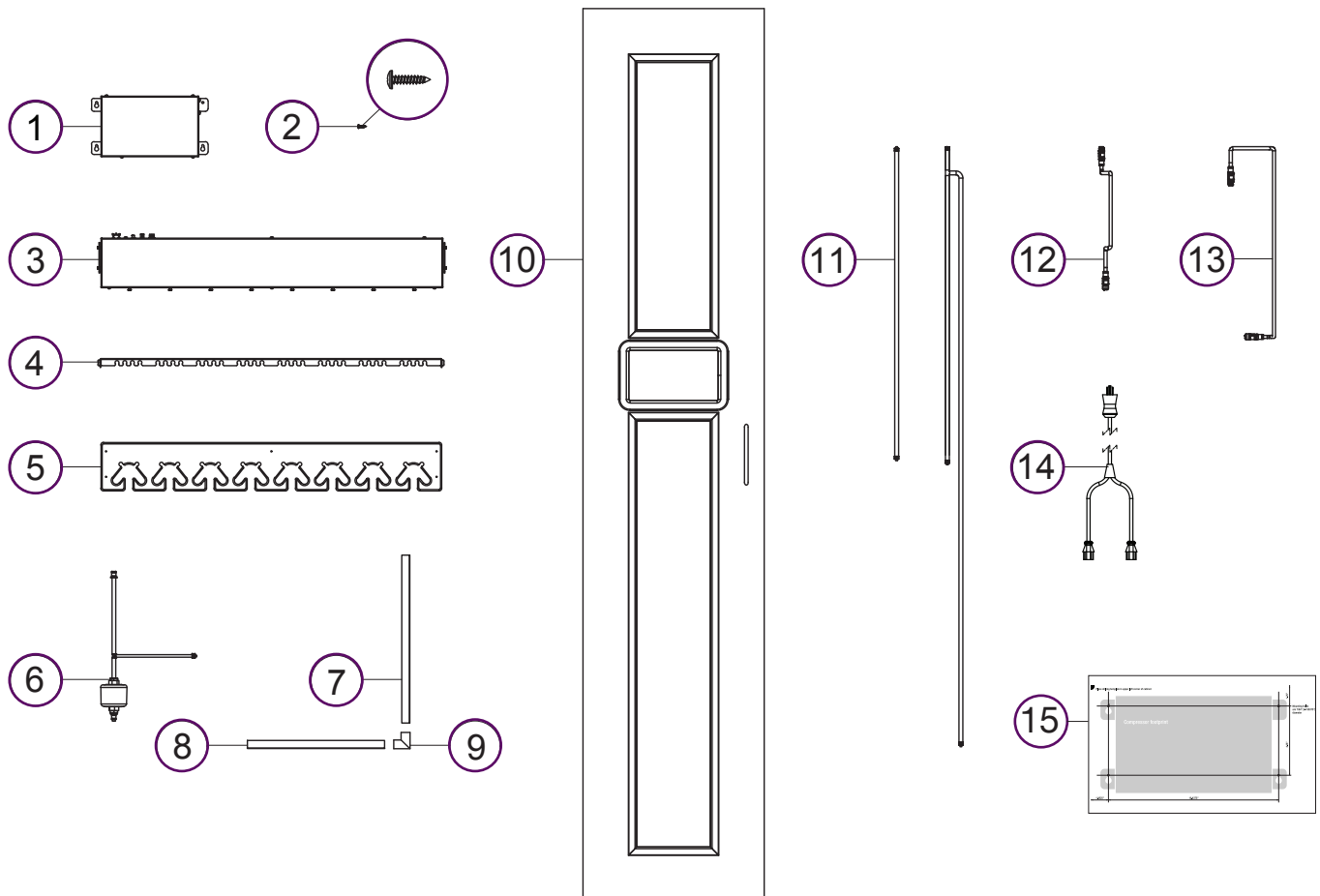

Attach Drying Components

Step 1

Remove endcaps from the bottom of the side rails and set aside

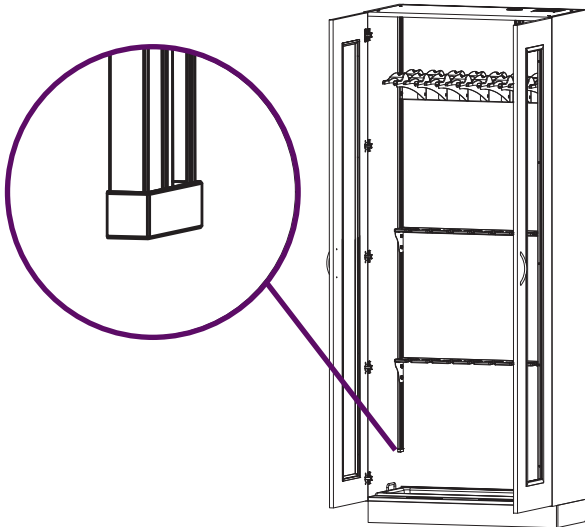

Step 2

Loosen the 4 thumb screws from the sides of the cord retainer bracket. Slide bracket down and remove from cabinet

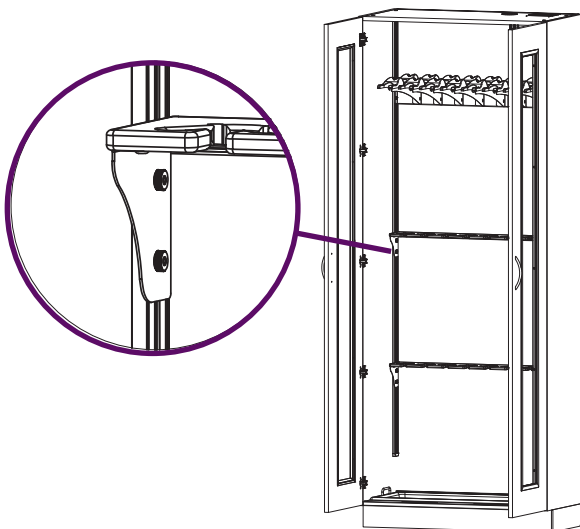

Step 3

Remove the 5 screws from the underside of the cord retainer bracket, and then remove the cord retainer

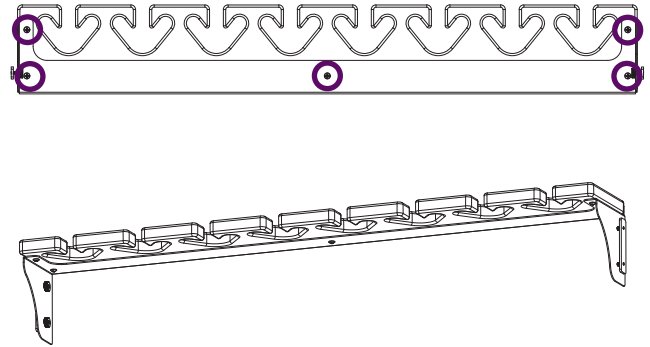

Step 4

Attach the new cord retainer to the bracket using the 5 screws. Set aside

Step 5

Position the template in the upper left corner to identify the locations for the pilot holes. Use drill with 7/64" bit to drill 4 pilot holes in the identified locations. Discard template

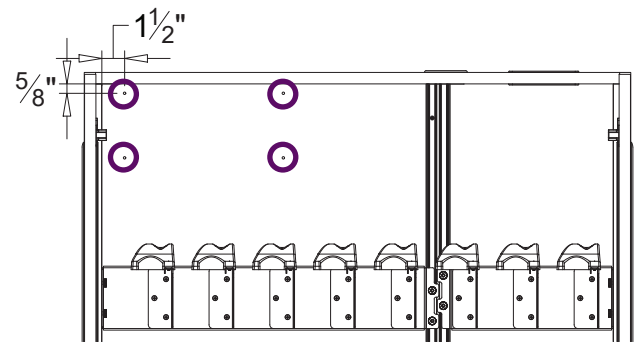

Step 6

Hold the compressor in place and attach to the cabinet using the 4 wood screws. Drill extender will be needed when securing the compressor with the 2 left screws

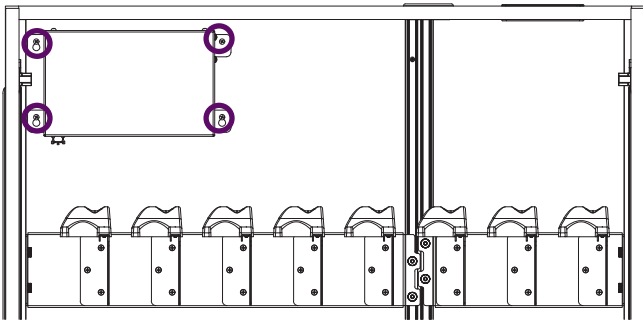

Step 7

Remove the 6 screws on the manifold cover and remove the cover. Slide the manifold onto the side rails in the groove in the back of the cabinet and position it 14" from the bottom of the compressor. Use a level to ensure the manifold is level, and then tighten the 4 thumb screws

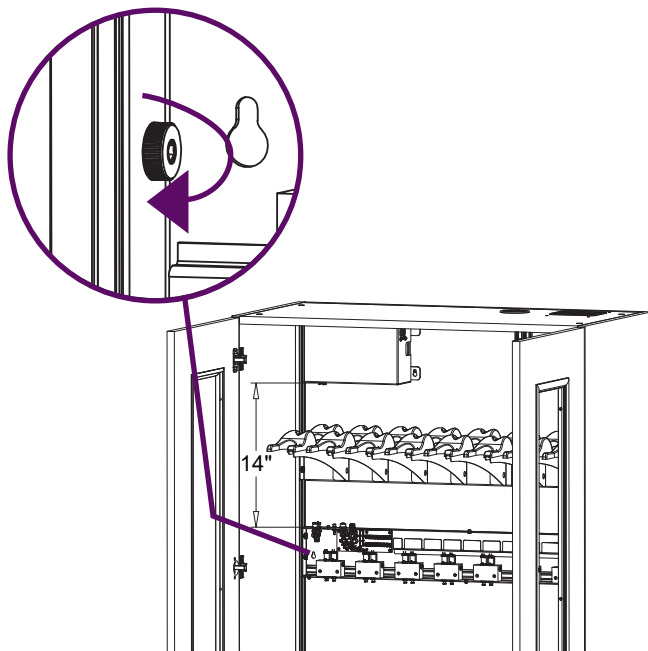

Step 8

Slide the manifold cover onto the manifold and tighten with 6 screws

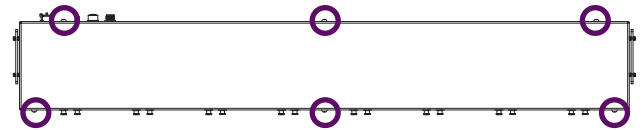

Step 9

Slide the tube management strip onto the side rails in the groove in the back of the cabinet and position it 26"-28" from the bottom of the manifold. Use a level to ensure the tubing strip is level, and then tighten the 2 thumb screws

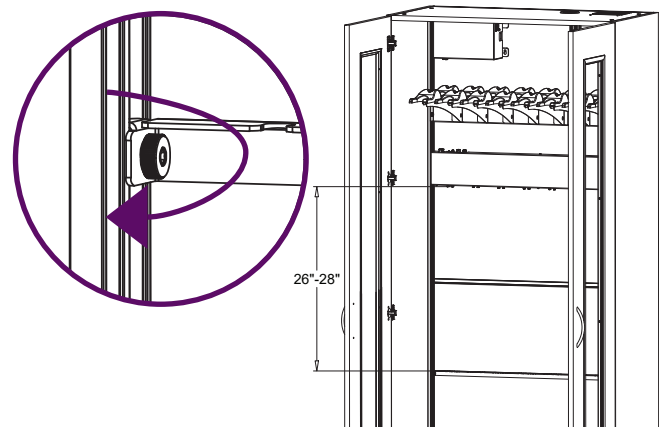

Step 10

Slide the cord retainer bracket onto the side rails in the groove in the front of the cabinet and position at desired location. Use a level to ensure the cord retainer is level, and then tighten the 4 thumb screws

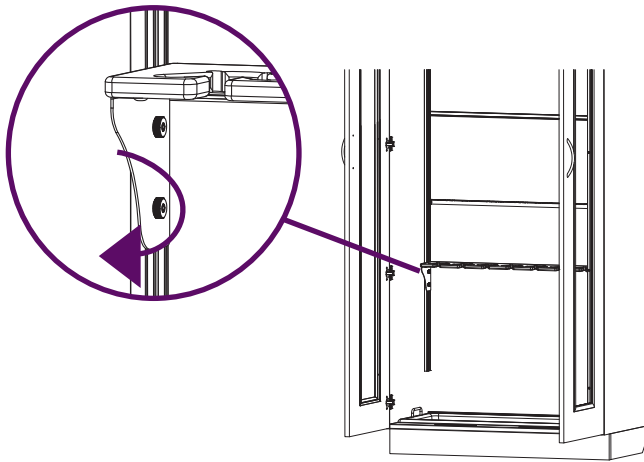

Step 11

Reattach the endcaps to the bottom of the side rails

Replace Existing Door

Step 1

To remove the existing door

1. Open the door and locate the hinges
2. Loosen the screws facing the front of the cabinet
1½ to 2 full turns to loosen but not remove the hinge



3. After all the screws are loosened, slide the door toward the inside of the cabinet. Remove the door



Step 2

Note that hinges on the retrofit door are shipped in the closed position



1. To open the hinge, insert the screwdriver tip under the back edge of the hinge, prying upward until the hinge opens. With your hand, open hinge completely



2. Place the door in front of the cabinet and lift it until it lines up with the hinges. Slide the door hinge into place. Tighten the mounting screws. Check alignment and adjust the hinge if necessary

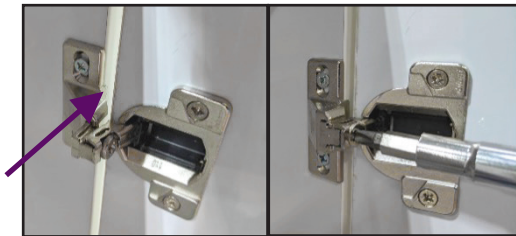

Attach Compressor Components

Step 1

To insert the compressor tube/filter

1. Insert the filter into the air filter port on the manifold
2. Insert the tube into the air output port connector on the compressor

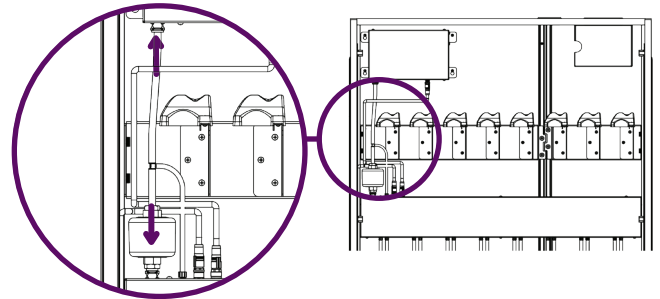

3. To attach the tube fitting, turn to the right until the fitting is firmly attached to the manifold

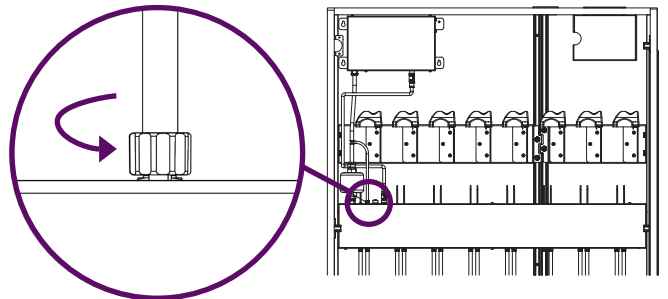

Step 2

To attach the compressor and manifold cable

1. Insert the 2' cable into the bottom of the compressor and turn to the right until tight

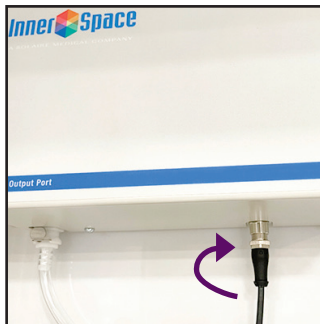

2. Run the cable behind the scope manager bracket

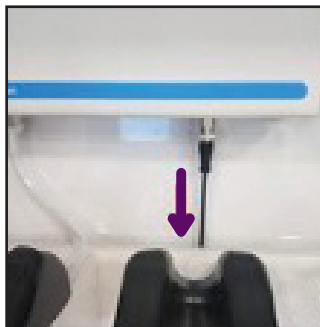

3. Insert the other end of the 2' cable into the manifold and turn to the right until tight

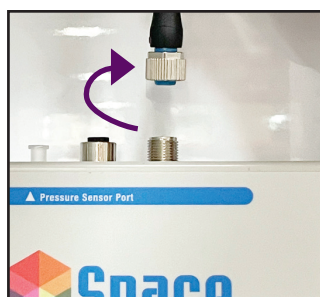

Attach Cable Raceway

Step 1

Attach the cable raceway

1. Position the 13½"-long straight raceway piece so the flat end is against the side panel and positioned horizontally
2. Center with the back of the LCD display, and place it 1½" from the front of the cabinet
3. Remove double-sided tape and press into place
4. Attach the 16½"-long straight raceway vertically so it lines up with the corner raceway after being attached
5. Connect the corner raceway by placing it over the vertical and horizontal raceways. Make sure you hear a click to indicate the raceways are connected

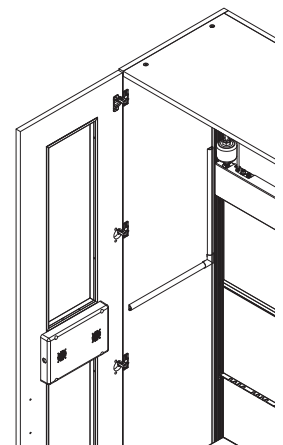
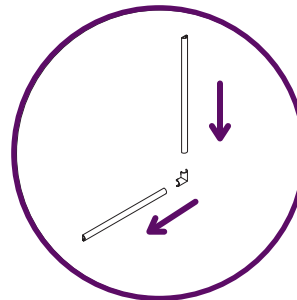

Attach Cable Raceway

6. Insert the 5' cable into the back of the LCD display and turn until tight



7. Run the cord through the horizontal, corner, and vertical raceways. Excess cord can be stored behind the scope manager bracket

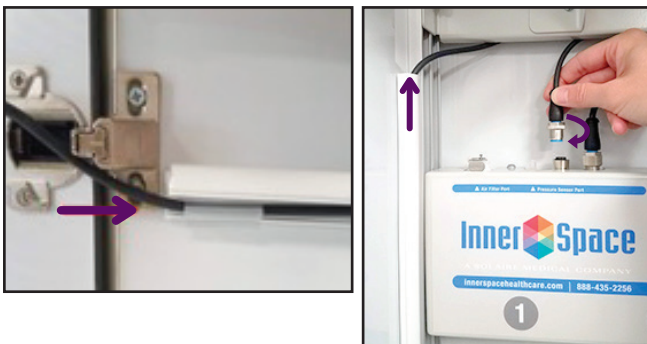

8. Attach the other end of the 5' cable to the manifold by turning until tight

Attach Manifold Tubing and Power Cord

Step 1

Attach the manifold tubing to the manifold by turning the hose fitting to the right until the tube is firmly attached

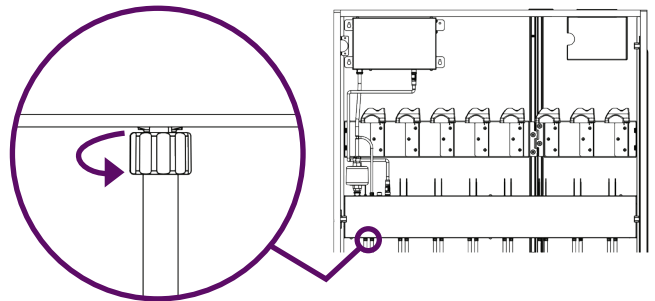

Step 2

Attach the power cord to the compressor & HEPA fan, and then pull through cord entry on top of cabinet. Plug into outlet

