

# Evolve Upper Cabinet with Adjustable Shelf and Hinged Door

---

**Evolve modular cabinets create a flexible storage system that organizes a hospital's most supply-intensive departments. A clean design and tight construction offer a refined aesthetic and support infection prevention efforts.** The 13"-deep, 30"-high cabinet comes in 3 widths. It has a

solid-front or tempered glass door and includes 1 adjustable full-width shelf. Material choices include compression board with a melamine or specified laminate surface, stainless steel, or nonporous AireCore with Glacier White finish, Brushed Aluminum finish, or specified laminate surface.



Aluminum channel on glass door

Concealed hinge design

Self-closing door

Aluminum tracks on cabinet interior accept LED lights

Keyed and InterConnect locks



# Evolve Upper Cabinet with Adjustable Shelf and Hinged Door

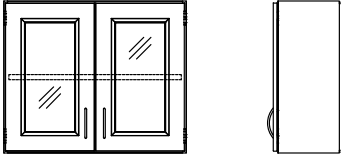

---

## Dimensions (nominal)

Exterior (interior):

18.75"w x 13"d x 30"h (17.25"w x 11.25"d x 28.5"h)

26.75"w x 13"d x 30"h (25"w x 11.25"w x 28.5"h)

36"w x 13"d x 30"h (34.5"w x 11.25"d x 28.5"h) (shown)

---

## Interior Configuration

Shelf adjusts in 1.25" increments

---

## Options

- Door can be hinged on right or left side of 18.75"w and 26.75"w cabinet
- Keyed, InterConnect lock, and proximity lock upgrade for InterConnect lock
- Sloped top
- InnerSpace Cloud for remote management and monitoring of cabinet security



# Product numbering system for Evolve Upper Cabinet with Adjustable Shelf and Hinged Door

Product Shown:  
SEC1336US

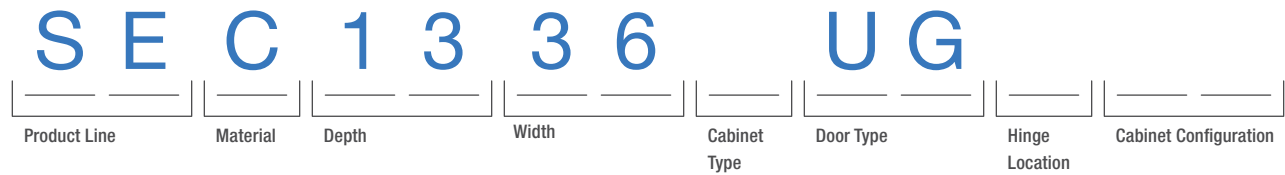

## Product Numbers

18.75"w x 13"d x 30"h

Compression board: SEC1319UGL, SEC1319UGR (shown), SEC1319USL, SEC1319USR (shown)

AireCore: SEA1319UGL, SEA1319UGR, SEA1319USL, SEA1319USR

AireCore and Brushed Aluminum: SEB1319UGL, SEB1319UGR, SEB1319USL, SEB1319USR

Stainless steel: SES1319UGL, SES1319UGR, SES1319USL, SES1319USR



## Product Numbers

26.75"w x 13"d x 30"h

Compression board: SEC1327UGL (shown), SEC1327UGR, SEC1327USL (shown), SEC1327USR

AireCore: SEA1327UGL, SEA1327UGR, SEA1327USL, SEA1327USR

AireCore and Brushed Aluminum: SEB1327UGL, SEB1327UGR, SEB1327USL, SEB1327USR

Stainless steel: SES1327UGL, SES1327UGR, SES1327USL, SES1327USR



## Product Numbers

36"w x 13"d x 30"h

Compression board: SEC1336UG, SEC1336US (shown)

AireCore: SEA1336UG, SEA1336US

AireCore and Brushed Aluminum: SEB1336UG, SEB1336US

Stainless steel: SES1336UG, SES1336US

# Evolve Upper Cabinet with Adjustable Shelf and Hinged Door

---

## Materials and finishes

### Cabinet shell:

- Compression board: Thermally fused melamine over 0.75"-thick compression board or specified Wilsonart, Formica, or Pionite standard laminate
- AireCore: Aluminum composite with Glacier White finish or specified Wilsonart, Formica, or Pionite standard laminate
- AireCore and Brushed Aluminum finish: Aluminum composite with Brushed Aluminum finish
- Stainless steel: 18-gauge 304 stainless steel with 18% chrome and 8% nickel analysis; exposed surfaces

### Edge banding:

- Compression board and AireCore: White ABS
- AireCore with Brushed Aluminum finish: Brushed Aluminum acrylic

### Solid-front door:

- Compression board: Thermally fused melamine over 0.75"-thick compression board or specified Wilsonart, Formica, or Pionite standard laminate
- AireCore: Aluminum composite with Glacier White finish or specified Wilsonart, Formica, or Pionite standard laminate
- AireCore and Brushed Aluminum finish: Aluminum composite with Brushed Aluminum finish
- Stainless steel: 18-gauge 304 stainless steel with 18% chrome and 8% nickel analysis

### Glass-front door:

- Compression board: Thermally fused melamine over 0.75"-thick compression board or specified Wilsonart, Formica, or Pionite standard laminate with tempered glass and clear anodized aluminum trim
- AireCore: Aluminum composite with Glacier White finish or specified Wilsonart, Formica, or Pionite standard laminate with tempered glass and clear anodized aluminum trim
- AireCore and Brushed Aluminum finish: Aluminum composite with Brushed Aluminum finish with tempered glass and clear anodized aluminum trim
- Stainless steel: 18-gauge 304 stainless steel with 18% chrome and 8% nickel analysis and tempered glass

### Hinges:

- Compression board, AireCore, and AireCore with Brushed Aluminum cabinet: Metal concealed European-style
- Stainless steel cabinet: Stainless steel

### Door pulls:

- Compression board, AireCore, and AireCore with Brushed Aluminum cabinet: Dull chrome-plated steel bow pull
- Stainless steel cabinet: 5" stainless steel bow pull