

Connector Kit 2 (SVCK2)

Follow these instructions to attach a connector to a scope.

Kit includes:

- Connector
- Biopsy port cover
- Auxiliary water connector

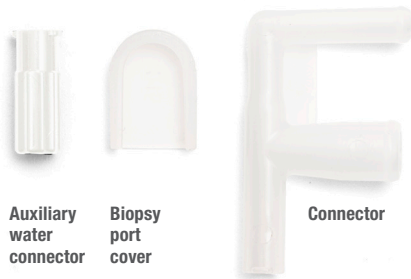

Step 1

Attach the connector to the manifold tube

Step 2

Insert the connector into the suction and air water valve ports below the control knobs on the scope body

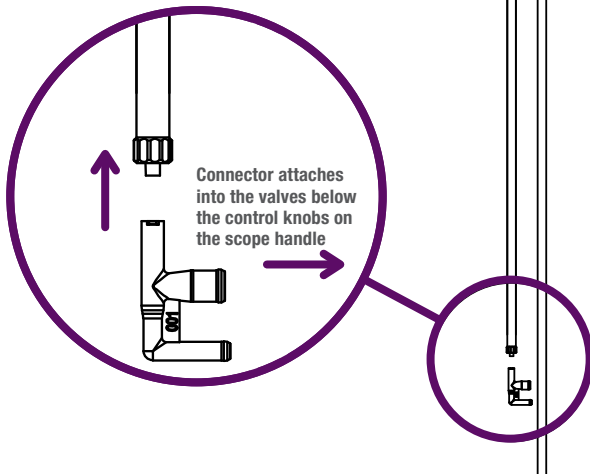

Step 3

Attach the auxiliary water connector to the manifold auxiliary water tube, and then screw the connector into the water jet port on the scope

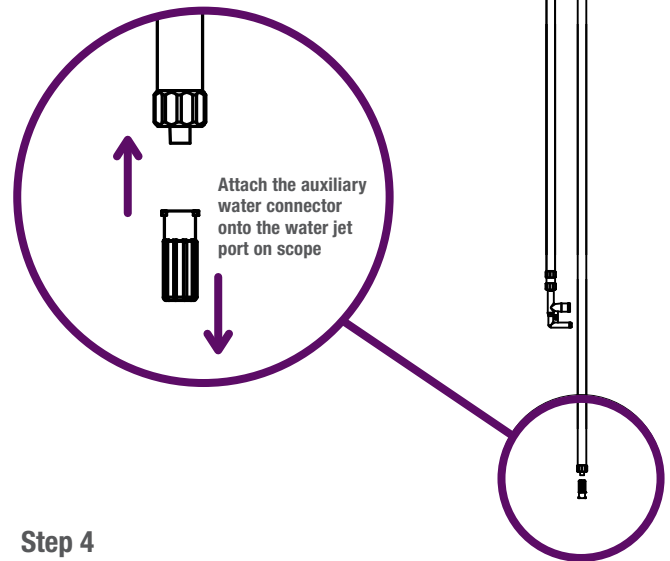

Step 4

Slide the cover onto the biopsy valve

