

Installation Instructions

Evolve Scope Pass-through Cabinet

Ventaire™ Endoscopy System

Scope Drying and Tracking Pass-through Cabinet



Installation Instructions

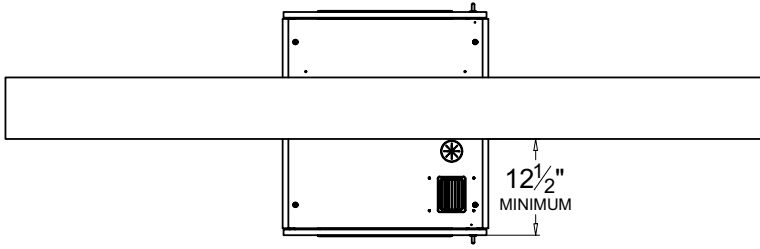

NOTE: USE APPROPRIATE FASTENERS FOR WALL TYPE

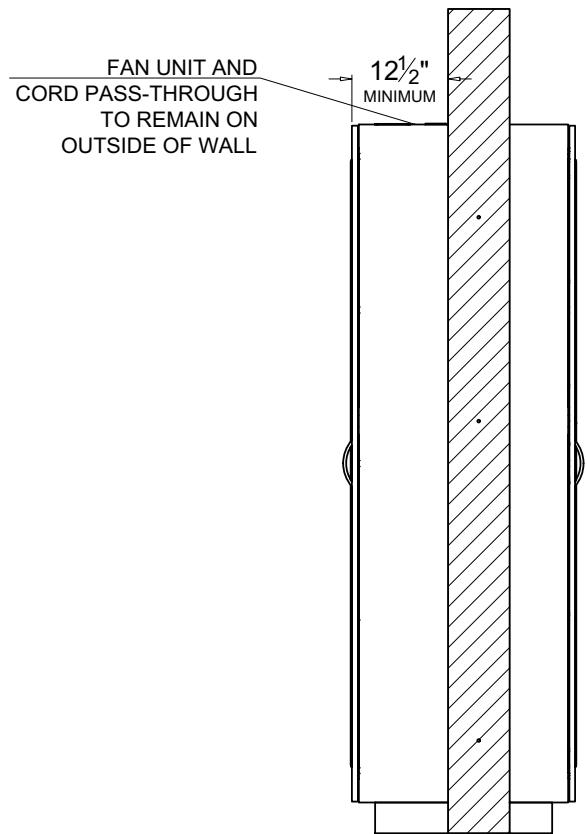
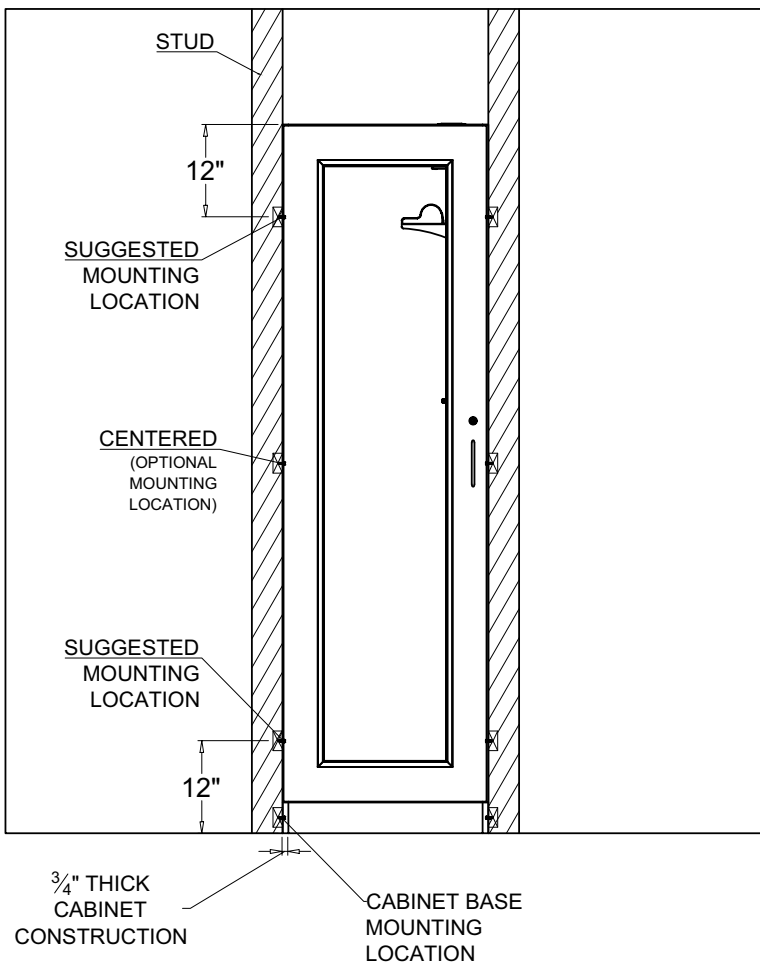

Installation Instructions

Follow these instructions to install Evolve scope pass-through cabinets constructed of AireCore or wood composite.



For installation of cabinets in the State of California, scan the QR code for pass-through cabinet instructions that include floor anchor kits.

Tools needed:

- Flat head screwdriver
- Wood screws for attaching multiple cabinets (if applicable)
- Level
- Hardware to attach cabinet to wall

Caution:

Pass-through cabinets can be unstable when handling, especially when the doors are open. Cabinets are shipped with bracing materials in place that should not be removed until the cabinet is in the location of installation.

Notes:

For ease of installation, we recommend predrilling all attachment locations on the cabinet and base.

Pass-through cabinets come with a fan unit vent and cord pass-through located at the top of the cabinet. These must remain on the outside of the wall and require a minimum 12½" clearance.

Preparing for cabinet installation

Step 1

Identify the location and placement of the cabinet. Clean floor and surrounding area.

Step 2

If infill panels are needed, attach infill panel directly to the sides of the cabinet with wood screws before installing cabinet.

Installing a single pass-through cabinet

Step 1

Position base into the wall opening. Access leveling feet inside of base. Using a flat head screwdriver, adjust the four leveling feet until the base is level.

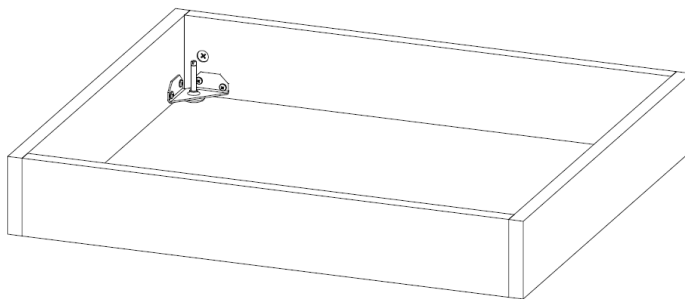

Step 2

Mount the base directly to wall studs using appropriate fasteners for the type of wall construction. Shim where needed to keep side of base plumb to wall.

Step 3

Place the cabinet on the base. Remove the bracing materials by removing the 2 attachment screws.

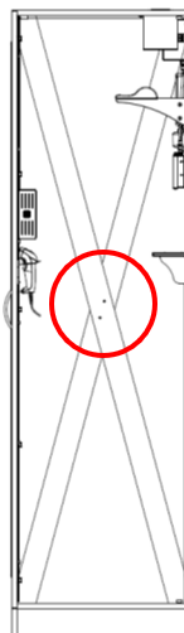

Installation Instructions

Step 4

Plumb the cabinet and secure it to the wall through the side panel(s) using appropriate fasteners. Shim where needed. At a minimum, one side panel should be connected to the wall. We recommended attaching to the wall on the same side as the door hinges. See figure for placement.

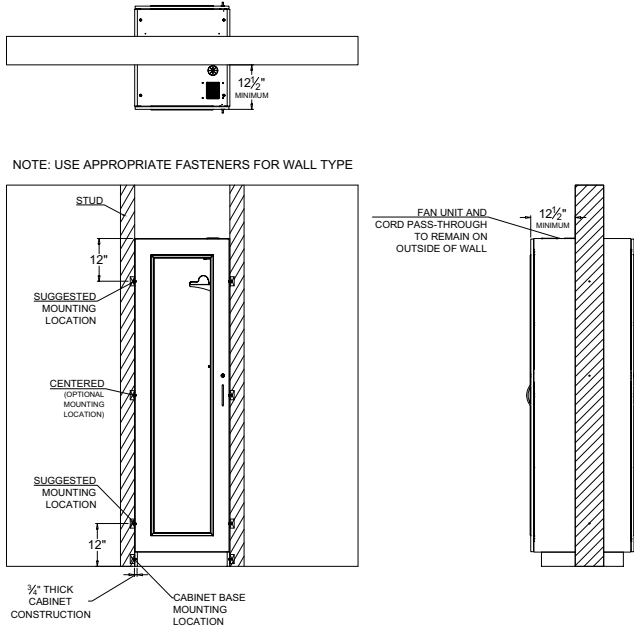

Step 2

Mount the bases directly to wall studs using appropriate fasteners for the type of wall construction. Shim where needed to keep sides plumb to wall.

Step 3

Place the end cabinet on the base. Remove the bracing materials by removing the 2 attachment screws.

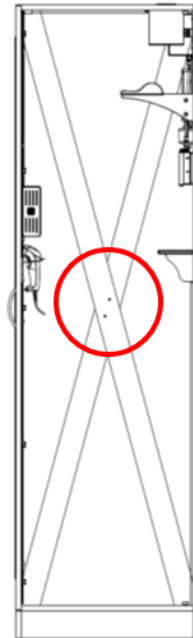

Installing multiple pass-through cabinets

Step 1

Attach the run of bases together using wood screws, making sure the bases are flush front to back and top to bottom. Position the run of bases into the wall opening. Access leveling feet inside of bases (4 per base). Using a flat head screwdriver, adjust the feet until the run of bases is level.

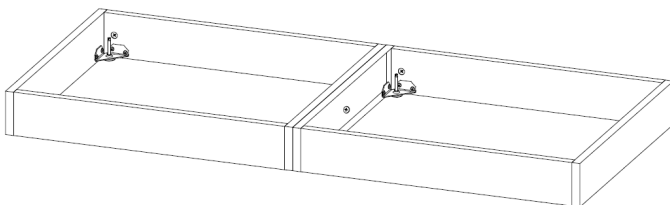

Step 4

Plumb the cabinet and secure it to the wall through the side panel using appropriate fasteners. See figure for placement.

Step 5

Add additional cabinet, making sure it is level and plumb. Attach to first cabinet through the side panel using wood screws.

Step 6

Repeat with additional cabinets, making sure each is level and plumb.