

Attaching a Side-Mounted Scope Cabinet to a Pace Cart

Follow these instructions to attach a side-mounted scope cabinet to a Pace cart.

Tools needed

- Hex key (included)
- Level (optional)

Attachment hardware included

Note: 2 people are required to lift and mount the scope cabinet.

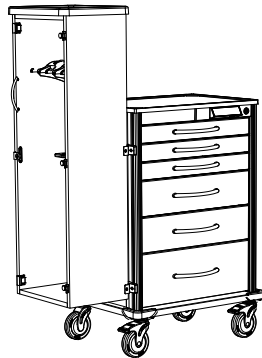

Step 1

Arrange the 4 T-nuts so that they sit on the last thread of the 4 screws on the scope cabinet's mounting brackets.

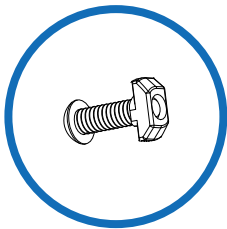

Step 2

Align the T-nuts vertically, and then push the mounting rails with cabinet into the 2 side corner channels on either the right or left side of the cart.

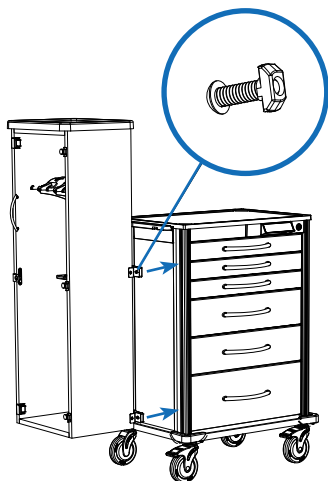

Step 3

Recommended: Use a level to ensure the scope cabinet is even.

Step 4

Using the hex key, firmly tighten the 4 screws on the mounting rails by turning clockwise. If a T-nut isn't tightening, make sure that the T-nut has been placed on the last thread of the screw.

