

## Evolve Wall-Mounted Ultrasound Cabinet with Hinged Door

Evolve modular cabinets and casework create a flexible storage system that organizes a hospital's most supply-intensive departments. A clean design and tight construction offer a refined aesthetic and support infection prevention efforts.

The 26.75"-wide, 19.25"-deep, 48"-high wall-mounted ultrasound cabinet has a tempered glass door. It is vented on the top and bottom and includes a removable drip tray. Material choices include compression board with a melamine or specified laminate surface, stainless steel, or nonporous AireCore with Glacier White finish, Brushed Aluminum finish, or specified laminate surface.

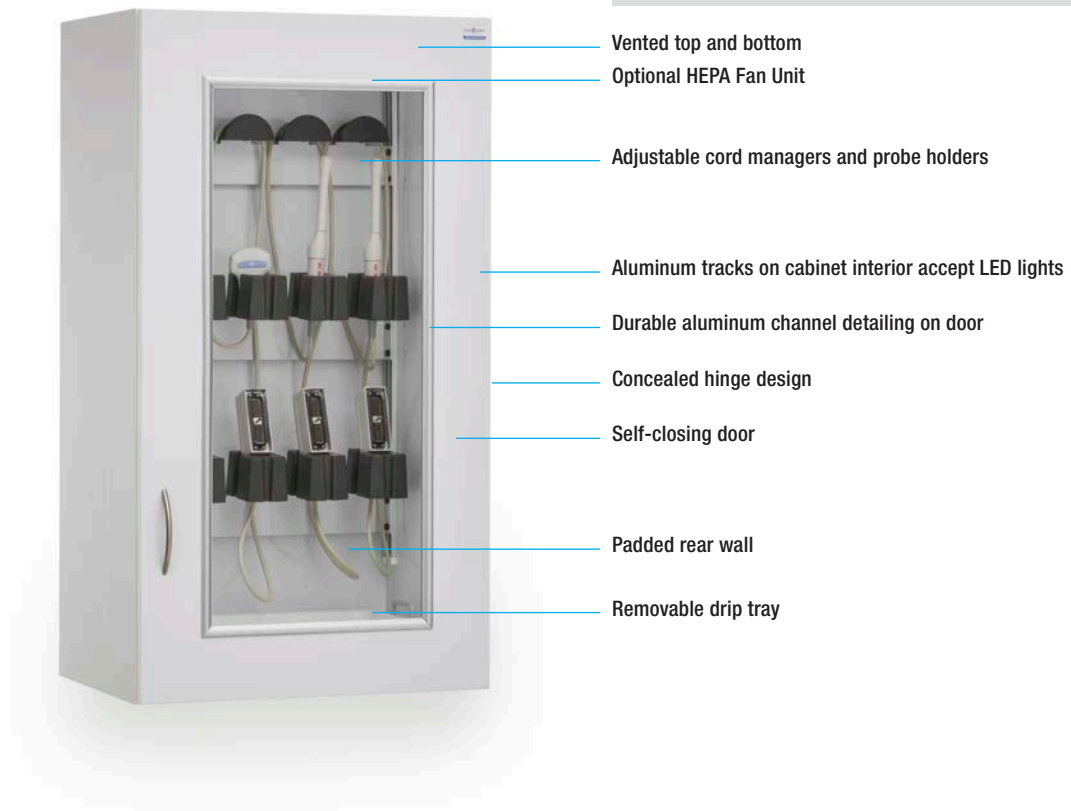

# Evolve Wall-Mounted Ultrasound Cabinet with Hinged Door

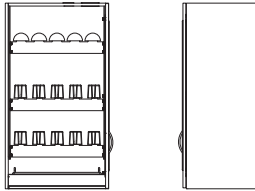

---

## Dimensions (Dimensions are nominal)

Exterior (interior)

**26.75"w x 19.25"d x 48"h (25.25"w x 17"d x 46.5"h)**

Interior Configuration:

**Cabinet holds 5 probes**

---

## Options

- Door can be hinged on right or left side
- Optional Fan Ventilation Unit; order separately (SFVU)
- Keyed or keyless lock options
- Optional sloped top

# Product Number Reference



Product Represented:  
**SEB1927PGRU**

<b>S</b>	<b>E</b>	<b>B</b>	<b>19</b>	<b>27</b>	<b>P</b>	<b>G</b>	<b>R</b>	<b>U</b>
Product Line	Material	Depth	Width	Cabinet Type	Door Type	Hinge Location	Cabinet Configuration	



## Product Numbers

26.75"w x 19.25"d x 48"h

**Compression board:** SEC1927PGRU, SEC1927PGLU

**AireCore:** SEA1927PGRU, SEA1927PGLU

**AireCore with Brushed Aluminum:** SEB1927PGRU, SEB1927PGLU



## Product Numbers

26.75"w x 19.25"d x 48"h

**Stainless steel:** SES1927PGRU, SES1927PGLU

# Evolve Wall-Mounted Ultrasound Cabinet with Hinged Door

---

---

## Materials and Finishes

### Cabinet shell:

**Compression board:** Thermally fused laminate over 0.75"-thick compression board; melamine surface or specified Wilsonart, Formica, or Pionite standard laminate

**AireCore:** Aluminum composite with Glacier White finish or specified Wilsonart, Formica, or Pionite standard laminate

**AireCore with Brushed Aluminum finish:** Aluminum composite with Brushed Aluminum finish

**Stainless Steel:** 18-gauge 304 stainless steel with 18% chrome and 8% nickel analysis; exposed surfaces

### Edge banding:

**Compression board and AireCore:** White ABS

**AireCore with Brushed Aluminum finish:** Brushed Aluminum acrylic

### Glass-front door:

**Compression board:** Thermally fused laminate over 0.75"-thick compression board; melamine surface or specified Wilsonart, Formica, or Pionite standard laminate with tempered glass and clear anodized aluminum trim

**AireCore:** Aluminum composite with Glacier White finish or specified Wilsonart, Formica, or Pionite standard laminate with tempered glass and clear anodized aluminum trim

**AireCore with Brushed Aluminum finish:** Aluminum composite with Brushed Aluminum finish with tempered glass and clear anodized aluminum trim

**Stainless steel:** 18-gauge 304 stainless steel with 18% chrome and 8% nickel analysis and tempered glass

### Hinges:

**Compression board, AireCore, and AireCore with Brushed Aluminum cabinet:** Metal concealed European-style

**Stainless steel cabinet:** Stainless steel

### Door pulls:

**Compression board, AireCore, and AireCore with Brushed Aluminum cabinet:** Dull chrome-plated steel bow pull

**Stainless steel cabinet:** 5" stainless steel bow pull



Storage solutions for healthcare

Solairé Medical | P.O. Box 2808 | Grand Rapids, Michigan 49501  
888-435-2256 phone | 616-743-5944 fax | [solairemedical.com](http://solairemedical.com)

© 2019 Solairé Medical, Grand Rapids, MI 49501  
© InnerSpace is a registered trademark of Solairé Medical, Grand Rapids, MI 49501  
0619